

FORM No. 1.

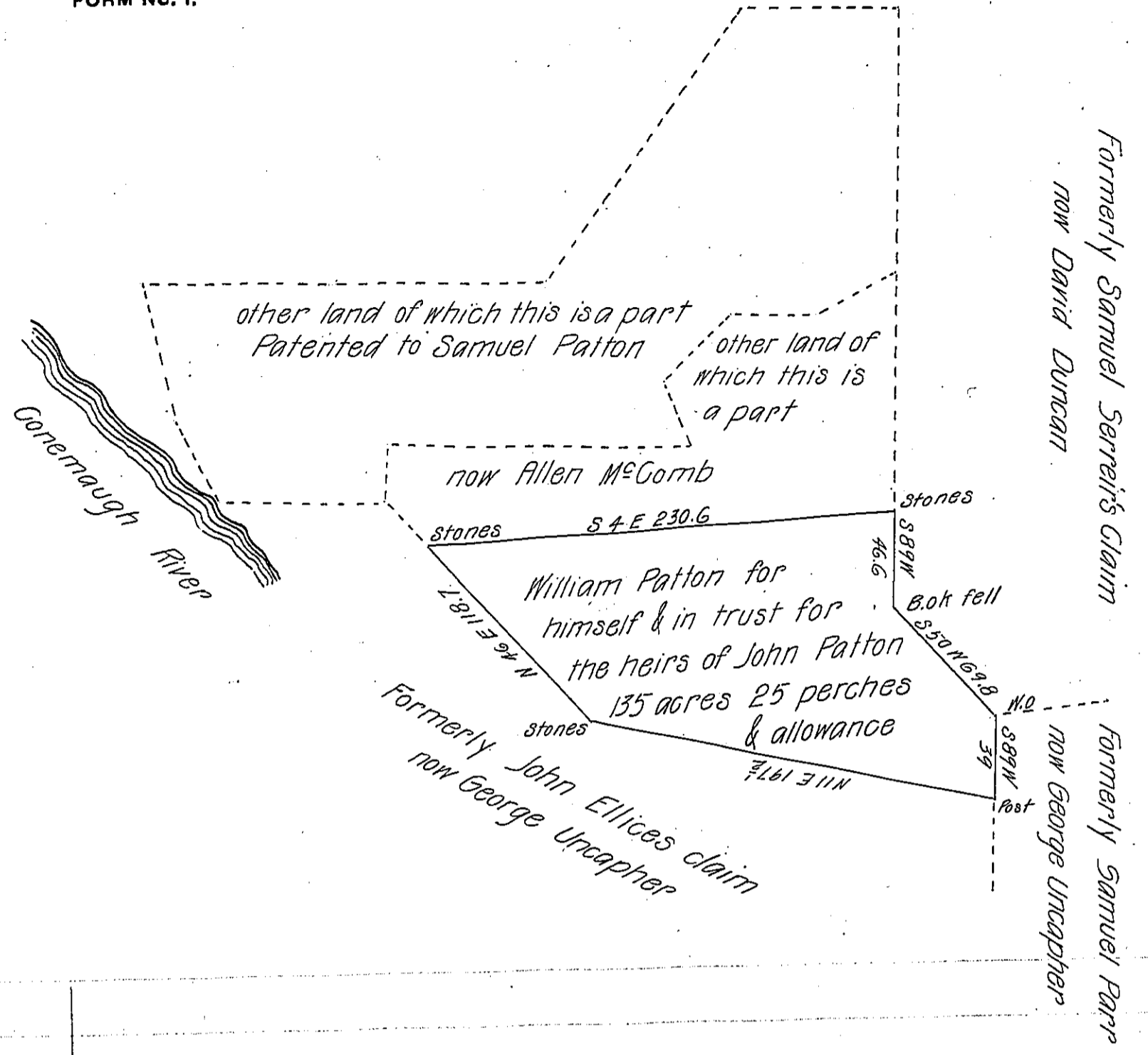

A draught of part of a tract of land which was surveyed for William Patton for himself & in trust for the heirs of John Patton in Pursuance of a Warrant dated November 6<sup>th</sup> 1786. Containing one hundred and thirty five acres twenty five perches and the allowance proportioned at six per cent for roads &c. Situate in Derry township in the County of Westmoreland Surveyed June 16<sup>th</sup> 1829.

G. L. Carpenter D.S.

Gabriel Hiester Esq.  
Surveyor General of Penna.

IN TESTIMONY that the above is a copy of the original remaining on file in the Department of Internal Affairs of Pennsylvania, made conformably to an Act of Assembly approved the 16th day of February, 1833, I have hereunto set my Hand and caused the Seal of said Department to be affixed at Harrisburg, this ninth day of July 1906.

*Isaac B. Brown*  
Secretary of Internal Affairs.